

# INDIAN TECHNO ACCESSORIES CO.

## MOULD BASES & DIE SETS ACCESSORIES

### 1) DME STD. EJECTOR PINS : EN 31

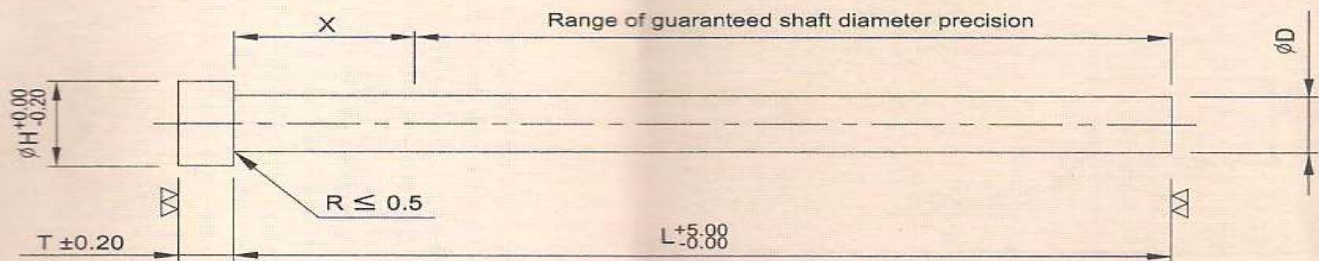

Range of guaranteed shaft diameter precision  
 $30 \leq X \leq 35$

**D dimension tolerances**

L \ D	D		
	$0.8 \leq 3$	$3.1 \leq 8$	$8.1 \leq 12$
$L \leq 300$	-0.01 -0.02	-0.01 -0.03	-0.02 -0.04
$L \leq 350$	-----	-0.02 -0.04	-0.02 -0.05

Head Dia. Collar( $\phi H$ )	Head Length $T \pm 0.2$	Pin Dia. ( $\phi D$ )	Length (L)							
			100	125	160	200	250	300	350	400
3.00	5.50	0.80	✓	X	X	X	X	X	X	X
3.00	5.50	1.00	✓	✓	✓	X	X	X	X	X
3.50	5.50	1.20	✓	✓	✓	X	X	X	X	X
3.50	5.50	1.50	✓	✓	✓	X	X	X	X	X
4.00	5.50	1.60	✓	✓	✓	X	X	X	X	X
4.00	5.50	1.80	✓	✓	✓	X	X	X	X	X
5.00	5.50	2.00	✓	✓	✓	✓	X	X	X	X
5.00	5.50	2.50	✓	✓	✓	✓	✓	✓	X	X
6.00	5.50	3.00	✓	✓	✓	✓	✓	✓	X	X
7.00	5.50	3.50	✓	✓	✓	✓	✓	✓	X	X
8.00	5.50	4.00	✓	✓	✓	✓	✓	✓	✓	✓
9.00	5.50	5.00	✓	✓	✓	✓	✓	✓	✓	✓
10.00	6.00	6.00	✓	✓	✓	✓	✓	✓	✓	✓
12.00	8.00	8.00	✓	✓	✓	✓	✓	✓	✓	✓
14.00	8.00	10.00	✓	✓	✓	✓	✓	✓	✓	✓
16.00	8.00	12.00	✓	✓	✓	✓	✓	✓	✓	✓
20.00	8.00	16.00	✓	✓	✓	✓	✓	✓	✓	X
24.00	8.00	20.00	✓	✓	✓	✓	✓	✓	✓	X

- ★ Hardness :- 48-52 HRC.
- ★ Dispatch Time for std. sizes is 3 working Days and for Non std. sizes 6 working Days.
- ★ Non Std. Ejector pins are also made to customers specification. Costing is given based on qty.
- ★ Order Example : EPNM -  $\phi D$  - L - Qty

EPNM - 3 - 160 - 12 Pcs.

## 2) DME STD. EJECTOR PINS : HDS (H 13)

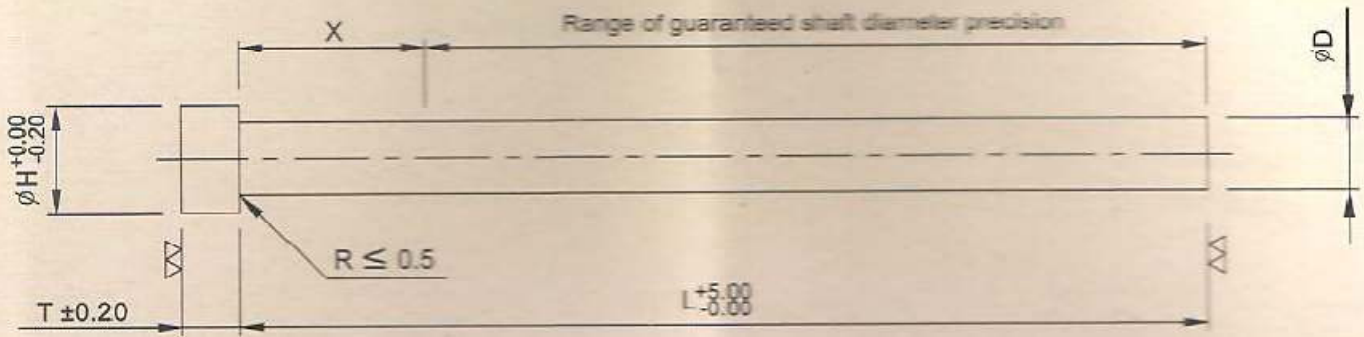

Range of guaranteed shaft diameter precision

$$30 \leq X \leq 35$$

D dimension tolerances

L	D	
	4.0 ≤ 8.0	8.1 ≤ 12
L ≤ 300	-0.01 -0.03	-0.02 -0.04
L ≥ 350	-0.02 -0.04	-0.02 -0.05

Head Dia. Collar( $\phi H$ )	Head Length $T \pm 0.2$	Pin Dia. ( $\phi D$ )	Length (L)							
			100	125	160	200	250	300	350	400
8.00	6.00	4.00	✓	✓	✓	✓	✓	✓	✓	X
9.00	6.00	5.00	✓	✓	✓	✓	✓	✓	✓	✓
10.00	7.00	6.00	✓	✓	✓	✓	✓	✓	✓	✓
12.00	9.00	8.00	✓	✓	✓	✓	✓	✓	✓	✓
14.00	9.00	10.00	✓	✓	✓	✓	✓	✓	✓	✓
16.00	9.00	12.00	✓	✓	✓	✓	✓	✓	✓	✓

- ★ Material :- HDS (H13)
- ★ Hardness :- 48 - 52 HRC.
- ★ Dispatch Time for std. sizes is 3 working Days and for Non std. sizes 6 working Days.
- ★ Non Std. Ejector pins are also made to customers specification. Costing is given based on Qty.
- ★ Order Example :  $\boxed{\text{EPND}} - \boxed{\phi D} - \boxed{L} - \boxed{\text{Qty}}$

EPND - 5 - 160 - 12 Pcs.